

NC3*XY

Assembly Instructions

1 Cable Requirements

- 1.1 Cable O.D. range (strain relief guaranteed): $\varnothing 4 \text{ mm} \div \varnothing 7 \text{ mm}$
- 1.2 Wire gauge (IDC width): AWG24 (0,22 mm²) to AWG26 (0,14 mm²)
- 1.3 Wire insulation outside diameter: $\varnothing \leq 1,5 \text{ mm}$

2 Cable Preparation

- Assemble bushing and chuck onto the cable.
- Strip the jacket of the cable as shown ($\approx 20 \text{ mm}$).
- Twist the shield carefully.

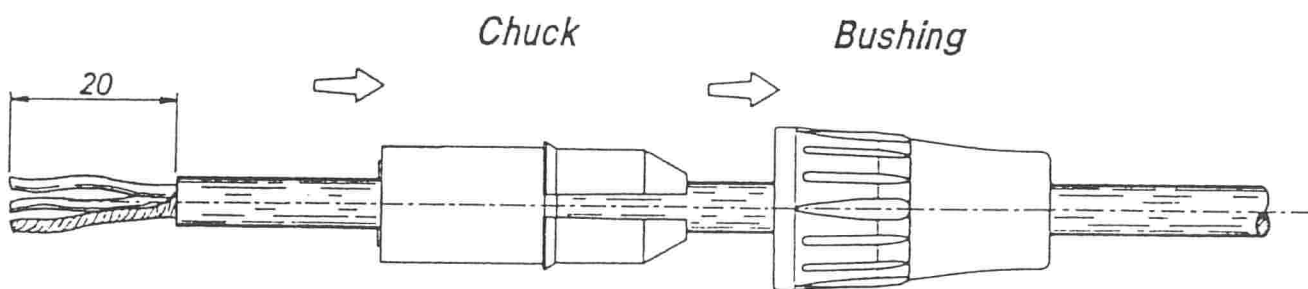

3 Assembly

□ Insert the wires into contacts '2' + '3' up to the inner stop (around 12 mm) and after that lift the ground contact and insert the twisted shield strands under the contact element.

Press the IDC contacts with your fingers and then force the chuck over completely up to the stop face.

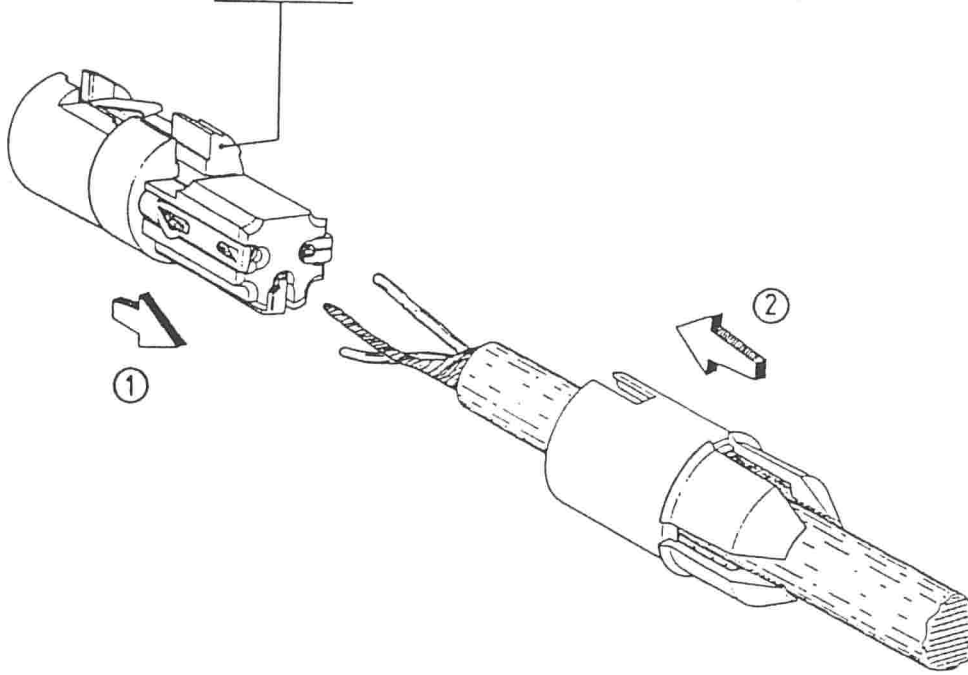

⚠ Note: There are two possible positions the chuck can be assembled. You can choose whether or not the housing will be grounded (connected to contact '1') by rotating the chuck 90°.

□ Push the housing onto the insert and screw on the bushing.

